

# MultiDos HighSpeed 37000

Liquid dosing system  
Vloeistofdoseersysteem  
Flüssigkeitsdosiersystem  
Système de dosage pour liquide

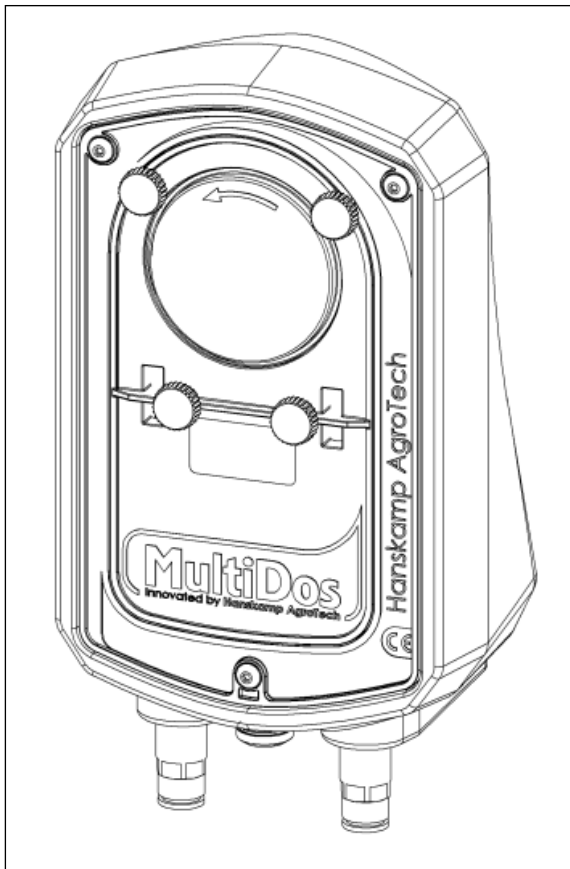

Installation and Operating Instructions

EN

Article number: 010-123-000

Date: December 2025

Version 2.4 - Translation of original Installation and Operating Instructions  
According to Annex 1 Section 1.7.4 of the Machinery Directive 2006/42/EC



**HANSKAMP**  
Innovation for dairy farming

Wehl,  
The Netherlands  
[www.hanskamp.com](http://www.hanskamp.com)

## Foreword

### Contents of the installation and operating instructions

This manual contains the information necessary for the correct installation and operation of a Hanskamp MultiDos HighSpeed. Please read this information carefully, and make sure you understand everything before configuring the MultiDos HighSpeed. Failure to do so could result in damage to equipment. Please consult your milking equipment dealer if you do not understand the information in this manual, or if you need additional information.

All the information in this manual was compiled with care. Hanskamp is not liable for any errors or shortcomings in this manual. The recommendations are intended as guidelines. All instructions, illustrations and specifications in this manual are based on the latest information available at the time of publication. Your MultiDos HighSpeed may have improvements, features, or options that are not covered in this manual.

### Applicability

The table below shows the type numbers of the MultiDos for which this manual is applicable.

### Model designation

Model	Type number
MultiDos Wall mount assembly HighSpeed	37003

### Contact number of milking technology dealer

We recommend that you enter the name, phone number and e-mail of your milking technology dealer in the table below, so that you can always find the right information easily.

Name	
Address	
Phone number	
E-mail	

## 1. Introduction

The MultiDos HighSpeed from Hanskamp is a piece of proven, sustainable technology that makes dosing the right amount of liquid additive per day and per cow very simple. It is a smart, fast and affordable solution. MultiDos HighSpeed doses liquid concentrates over feed as if it were gravy, and cows love it.

The information in this manual is intended for dairy farmers and technicians.

- Dairy farmers can use the information to test and adjust the MultiDos HighSpeed.
- Technicians can use the information to install and set up the MultiDos HighSpeed.

## 2. Safety

### 2.1 Introduction

The 'Safety Warning' symbol warns about important safety messages on your MultiDos HighSpeed and in the manual. Use caution if you see this symbol; it means there is a risk of personal injury or death. Follow the directions of any safety messages.



*Safety Alert Symbol*

### 2.2 Warning Texts

Note the use of the warnings **CAUTION** and **DANGER** in the safety messages. The following guidelines apply to these warnings:



**Warning!** Indicates a potentially hazardous situation which could result in minor personal injury or damage to equipment or the environment if the warning is ignored.



**Danger!** Indicates a potentially hazardous situation which could result in death or serious injury if ignored.

### 2.3 Safety Instructions

You are personally responsible for operating and maintaining your MultiDos HighSpeed safely. You must make sure that you and anyone else who operates the equipment, performs maintenance on the MultiDos HighSpeed or works in the vicinity of the MultiDos HighSpeed, are familiar with all the safety information in this manual.

Safety is in your hands. Proper safety measures protect you and the people around you. Incorporate these measures into your safety programme. Make sure that everyone who uses, carries out maintenance, or works in the vicinity of the MultiDos HighSpeed is aware of these safety measures. Do not risk injury or death by ignoring the safety precautions.

- MultiDos HighSpeed owners must train users before the MultiDos HighSpeed is used. This training must be repeated at least once a year.
- The user must read, understand and follow all the safety and operating instructions in the manual.
- Anybody who has not read and understood all the safety and operating instructions must not operate the MultiDos HighSpeed.
- Do not make any modifications to the equipment. Unauthorised modifications may affect operation, affect the service life of the equipment, and/or result in personal injury.
- Only use original spare parts, and make sure that they are fitted by authorised technicians.

### 2.3.1 General safety

- Make sure that you have read and understood the manual and the safety instructions before connecting the power supply to operate or adjust the MultiDos HighSpeed, or turning it off for maintenance.
- Only trained persons may operate the MultiDos HighSpeed.
- A first-aid kit must be available near the MultiDos HighSpeed. Store in a highly visible place.
- A carbon dioxide or foam fire extinguisher must be available near the MultiDos HighSpeed. Store the fire extinguisher in a highly visible place.
- Install all guards and safety devices before using the MultiDos HighSpeed.
- Wear proper protective clothing and equipment.
- Before cleaning the MultiDos HighSpeed or performing maintenance on it, switch off the power supply of the MultiDos HighSpeed by removing the plug from the socket.
- Make sure that phone numbers of emergency medical care available in your area are at hand.
- If you have any other questions, please contact your milking technology dealer.
- Review all safety-related topics with all users at least once a year.

### 2.3.2 Electrical safety

- Only an authorized electrician must install the electrical power supply for the MultiDos HighSpeed.
- Make sure the electrical grounding of the electrical system and all parts of the MultiDos HighSpeed meet the local rules and regulations.
- Replace any damaged electrical lines, conduits, switches and components immediately.
- Isolate the electrical power supply before you open the MultiDos HighSpeed to work on the electrical system.

### 2.3.3 Safety during installation

- Make sure that you have read and understood the instructions in this manual.
- Check whether the MultiDos HighSpeed has been installed correctly, as described in the manual.

### 2.3.4 Safe operation

- Make sure that you have read and understood the manual and the safety instructions before connecting the power supply to operate or adjust the MultiDos HighSpeed, or turning it off for maintenance.
- Only trained personnel may operate the MultiDos HighSpeed.
- Before cleaning the MultiDos HighSpeed or performing maintenance on it, switch off the power supply of the MultiDos HighSpeed by removing the plug from the socket.
- Install the lid and other safety devices before using the MultiDos HighSpeed.
- Keep hands, feet, hair and clothing away from live parts.
- Keep all unauthorised persons, especially small children, away from the MultiDos HighSpeed at all times.
- Before connecting the MultiDos HighSpeed to the power supply, make sure that all parts are properly tightened and that all cables and mountings are in good condition.
- If you have any other questions, please contact your milking technology dealer.

### 2.3.5 Maintenance safety

- Make sure that you have read and understood the manual and the safety instructions before connecting the power supply to operate or adjust the MultiDos HighSpeed, or turning it off for maintenance.
- Only trained personnel may service and maintain the MultiDos HighSpeed.
- Before cleaning the MultiDos HighSpeed or performing maintenance on it, switch off the power supply of the MultiDos HighSpeed by removing the plug from the socket.
- Wear protective clothing and safety goggles when you do work on the pneumatic system.
- Make sure all guards and safety devices are installed when you have finished maintenance work.

### 2.3.6 Safety messages

- This chapter lists the general safety messages. Specific safety messages, where potential hazards may arise if the procedures or instructions are not followed, are included in the appropriate sections of this manual.

### 3. Installation and operating instruction

#### General description

The Hanskamp MultiDos HighSpeed-dosing system is a liquid dosing system. The MultiDos HighSpeed is suitable for fluids with a low viscosity like Glycerine and Propylene glycol. The MultiDos HighSpeed is not suitable for fluids with a high viscosity for example molasses. The MultiDos HighSpeed can be connected to any general feeding system, just like the PipFeeder and other Hanskamp dosators.

This instruction will help you to install the MultiDos HighSpeed system (figure 1). Read this instruction carefully and follow the safety instructions. Examples of installation can be found at [www.hanskamp.com](http://www.hanskamp.com).

Order numbers and names of accessories can be found in the attachment.

#### Transport and storage

A complete MultiDos HighSpeed system set consists out of a MultiDos HighSpeed wall mount, a pressure hose, suction hose and a nozzle. The wall mount will be send in a box. These boxes can be put on each other on a pallet.



**Caution!** Always move the pallet using a suitable means of transport (forklift, pallet fork, pallet truck, etc.).

**Caution!** When unpacking the pallet, parts may fall from it.

#### Safety

The user and installer are responsible for operating and maintaining the MultiDos HighSpeed safely. In case of changing the HanskampQualityTube of the pump (art. no. 003-512-00), always disconnect the electric system to prevent dangerous situations.

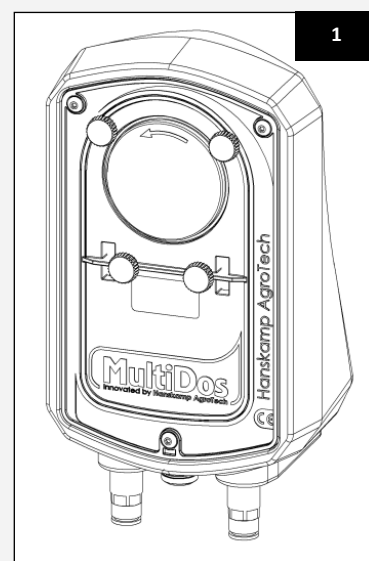

**Type description;**  
to be found on the pump housing

**Caution:** the stickers present may not be removed!

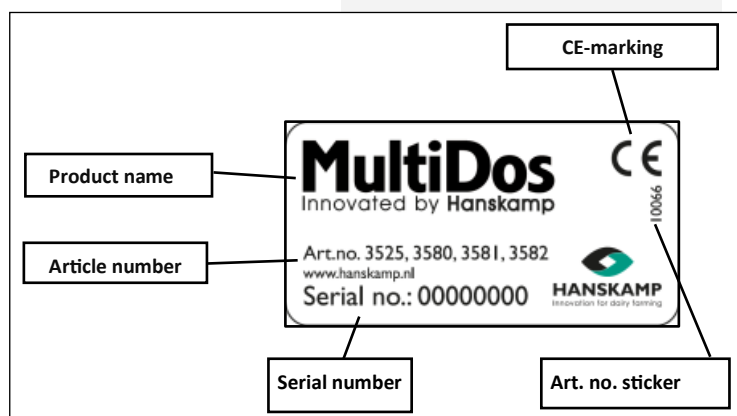

#### Maintaining stickers

- Keep safety stickers clean and legible.
- Clean safety stickers with soap and water.
- Do not use solvents or abrasives that could damage safety stickers.
- Replace missing or illegible safety stickers.
- Safety stickers are available from Hanskamp. Always use the article numbers in correspondence.

## Wall mount assembly

1. Check if all the parts are present using the item list.
2. Unscrew the outermost 3 socket screws (art. no. 003-510-000) from the MultiDos HighSpeed pump and remove the pump.



**Attention! Place the housing up to a maximum of 2 meters from the bottom of the storage tank.**

The MultiDos HighSpeed can be mounted on two different ways.

- 3a. Attach to a wall:  
Mount the DIN rail provided vertically on the wall. Mounting material is not included. Then slide from the top of the wall mounting over the DIN rail (fig. 4).
- 3b. Mount it to a background:  
Drill holes into the bottom of the MultiDos HighSpeed. You can determine the placement of the holes yourself; the minimum distance between the hoses and plate is illustrated in figure 4. Attach the wall mount. Mounting material is not included.

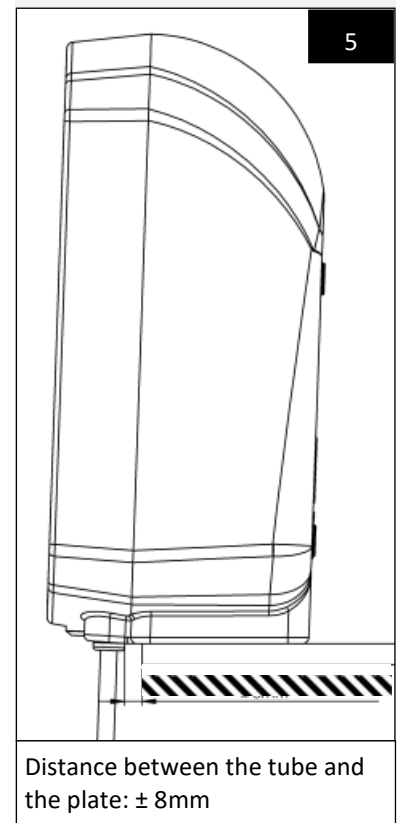
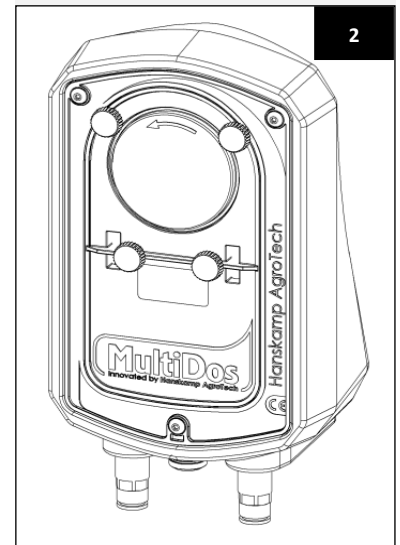
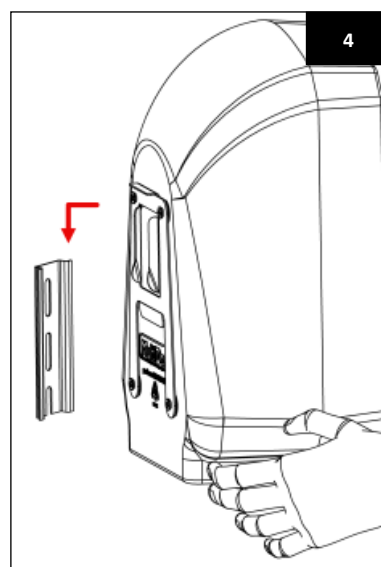
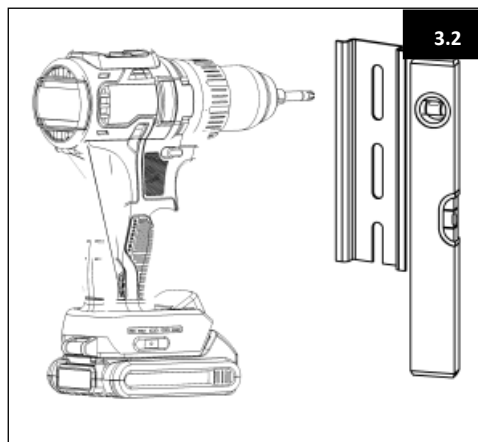
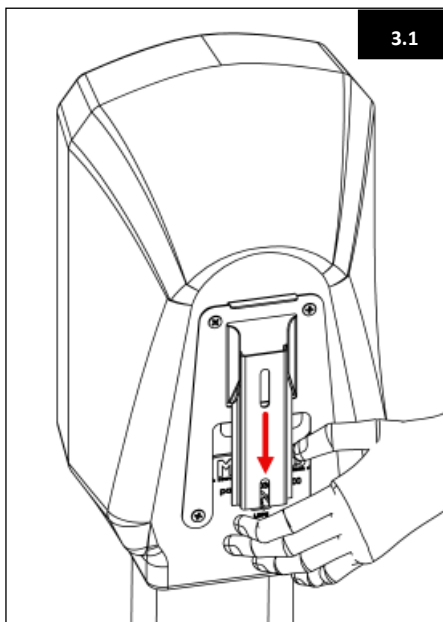



4. Unscrew the lid of the pump housing.
5. Make a hole in the middle nozzle with a small, flat screwdriver. Push the engine cable (art. no. 001-753-000) through the nozzle. Connect this cable to the engine using 2 Wago clamps (art. no. 001-875-000). (Brown to red and white to green.) Connect the cable to the corresponding control system. For correct installation, refer to the installation manual for the corresponding control unit. Do this when the installation is complete.
6. Mount the following items: 001-453-000, 001-486-000 and 011-021-000 as illustrated in figure 7.
7. Use the accompanying screws (art. no. 003-510-000) to fix the pump housing to the wall mount.
8. Unscrew the rotor from the motor and remove it from the motor shaft by pulling it upwards.

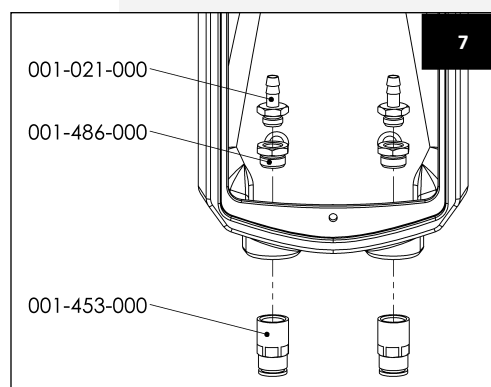
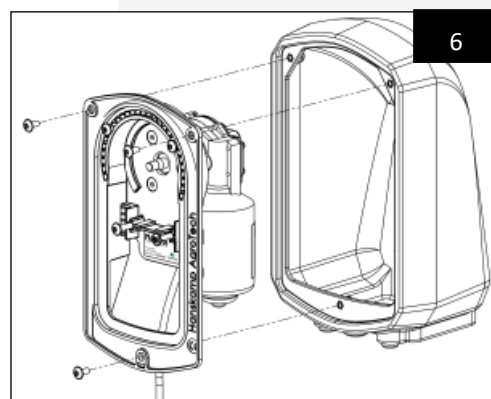

**Attention! By loosening of the rotor by hand, minor injuries can occur.**



**Attention! Hanskamp only guarantees a correct operation when the suction hose is 2 meters or shorter. Use the 5 meter hose as a pressure hose.**



**Attention! HanskampQualityTube is not suitable for acids. A suitable hose kit for acids can be ordered from Hanskamp upon request.**



**Attention! Cut the hose off straight. When the hose is cut off skewed, it may impair the operation.**



**Attention! Make sure that the end of the suction hose is placed at the bottom of the container, otherwise the pump cannot pump all the liquid.**

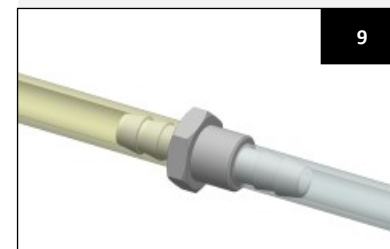
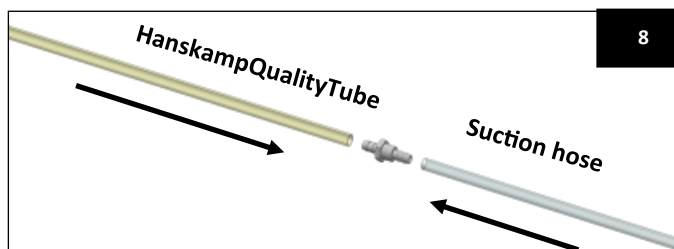

9. Take the right sight of the HanskampQualityTube and place it on the hose tailpiece (art. no. 001-021-000) (figure 10).
10. Bend the HanskampQualityTube round and slide it over the hose tailpiece (art. no. 001-021-000) on the left side.
11. Attach the suction hose (art. no. 082-254-100 max. 2 metres) to the right side of the insert coupling.
12. Insert the pressure tube (art. no. 082-254-100) into the insert coupling, making sure it is fully inserted to prevent leakage.
13. Bend the HanskampQualityTube into the shape of the pump housing as much as possible (figure 12).

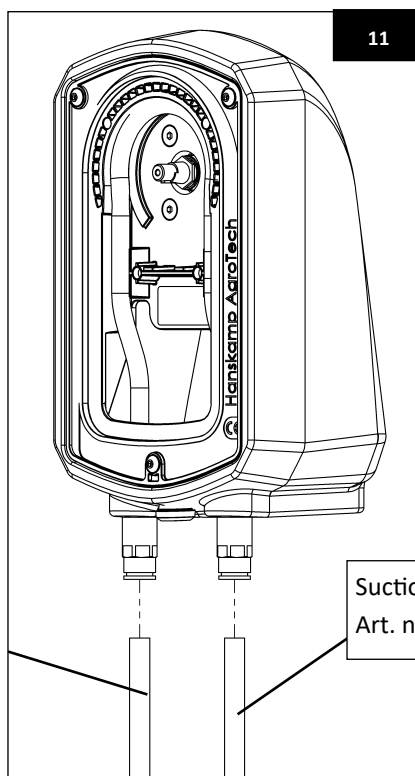
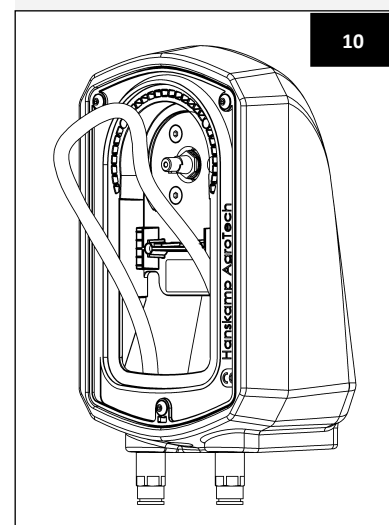

Pressure hose  
Art. no. 082-254-100

Suction hose max. 2m.  
Art. no. 082-254-100

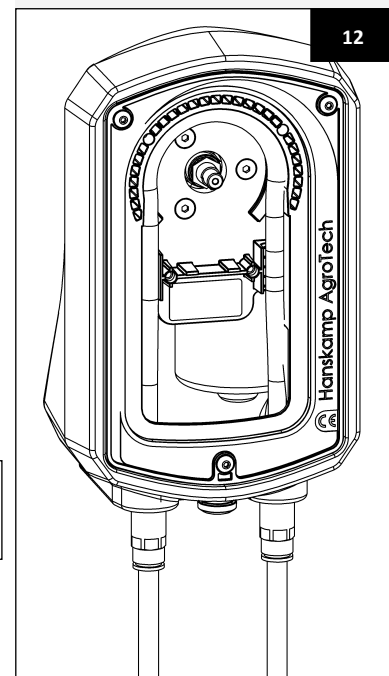

14. Mount the rotor onto the shaft of the pump motor as illustrated in figure 13. Push the HanskampQualityTube in between the rollers and the pump housing with a turning motion. The HanskampQualityTube is now wedged between the rollers and the pump housing.



**Note! the tube must be as tightly packed as possible in the curve of the pump housing.**

15. Take the transparent pump lid (art. no. 003-502-000) and the 4 corresponding knurling bolts (003-509-001). Position the lid so that it is immediately in front of the opening of the pump housing. Tighten the screws evenly until the lid is secure. Note: tight is tight! (figure 15).

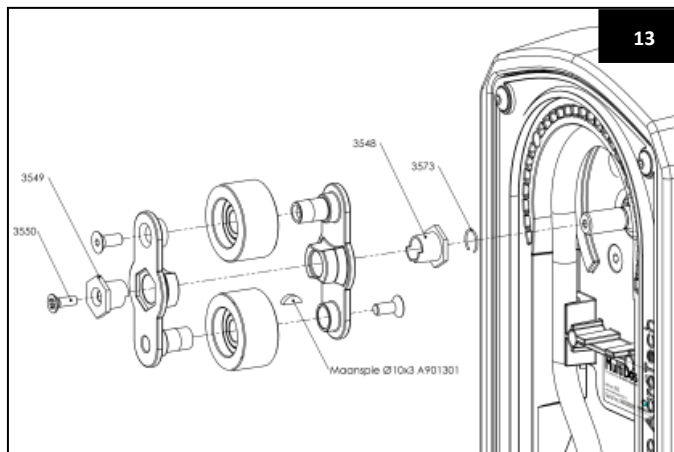

16. Connect the motor of the MultiDos HighSpeed to the corresponding control system. Disconnect the feed station control board from the power supply before connecting the motor cable.



**Caution! Light electric shocks can occur when connecting the motor to the control board.**

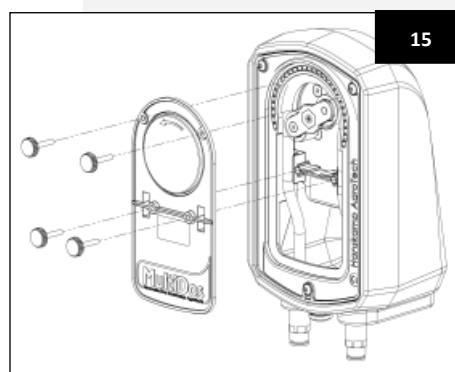

#### Maintenance

Check the MultiDos HighSpeed system daily for malfunctions and wear. Perform a visual inspection of the supply and discharge hoses and electrical wiring. Periodically check the dispensing quantity and calibrate if necessary. When the HanskampQualityTube is worn by intensive use (leaking), replace it according described steps. A repair kit is available by Hanskamp. Also check the rollers and bearings for wear. Check the rollers and bearings for wear as well. These are also available from Hanskamp if necessary.

#### Calibration

For calibration: operate the motor manually till the liquid emerges from the nozzle.

The MultiDos HighSpeed can be calibrated by having the feed computer send out a pulse 10 times. Then measure the dispensed liquid and divide it by 10, enter this value into the feed computer. Repeat this procedure once a month and after changing liquid. Liquid concentrate is distributed simultaneously with normal concentrate over the entire active period of the day. Refer to your feed computer's manual on how to use the feed curve. This is one of the calibration methods. If the calibration method is described differently in your feed computer's manual, you should apply that calibration method to the MultiDos HighSpeed.

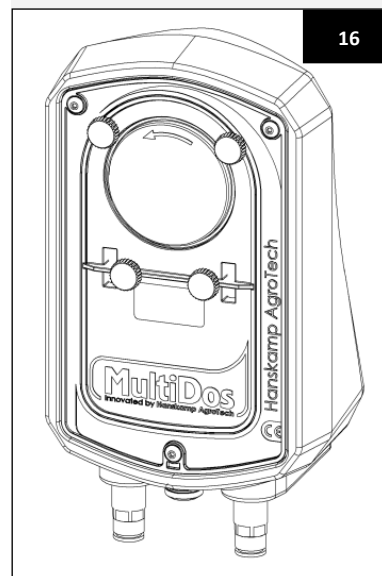



**Caution! In case of maintenance make sure to always first switch off the voltage and ensure that the storage container is empty, to prevent light electric shocks.**

#### Disassembly

In case of disassembly all parts should be separated on material type and should be processed in the right type of waste management system.



**Caution! When disassembling the MultiDos HighSpeed, there is a risk of clamping danger. Also watch out for slight injuries on the hand, by grasping into the roller mechanism.**



**Caution! During the cleaning of the tubing (flush) and grasping into the roller mechanism with your hands, small injuries can occur on your hand. With an uncovered motor (no cover mounted) watch out for light electric shocks.**

#### Overview of included changes in this installation-and operating instruction

No.	Release date	Chapter(s)	Notes
1	09/2015		First edition
2	08-2018	All	Replace couplings
3	10-2019	Multiple	Replaced images
2.2	01/2023	Page 14	UKCA logo added
2.3	08/2024	Pages 8 + 19	Page 8 Adjusted images and added DIN rail text for wall mounting. Page 19 New article numbers added for wall mounting.
2.4	12/2025	Pages 1 + 20	Page 1 Change of place name. Page 20 Change of address Hanskamp.

#### Warranty limitations

Costs and expenses resulting from the following are excluded from the warranty:

- Using the equipment improperly, in violation of the specifications in the installation and operating instructions;
- The consequences of any intervention by mechanics other than mechanics approved by Hanskamp for carrying out certain work;
- Incidents such as freezing, ice, fire, flood, flooding or any other problems caused by excessive water, and lightning;
- Defective electrical system or earthing;
- Using compressed air that does not meet Hanskamp's quality standards;
- Damage to the electrical system caused by pests and the like.

The warranty does not apply to consequential damages unrelated to the machine itself.

All systems have been tested, However, in the event of defects, Hanskamp AgroTech BV

#### Copyright and disclaimer

The information in this publication is for informational purposes only, and is not intended as a sales quote. The products offered may differ from the images. Any brand or product references in this manual are for identification purposes only. The company and product names mentioned in this manual are trademarks. No part of this publication may be reproduced or made public without the prior written consent of Hanskamp AgroTech BV. Although this publication has been compiled with the greatest care, Hanskamp AgroTech BV is not liable for any damage that may arise due to any errors or omissions it might contain. The Dutch installation and operating instructions are the original installation and operating instructions. Translations into other languages are based on the Dutch installation and operating instructions as a source document. Hanskamp AgroTech BV accepts no liability for differences between the translations. If there are any doubts about the content and accuracy of the translated installation and operating instructions, the Dutch installation and operating instructions shall prevail.

## 4. FAQ

Common problem	Possible cause	Solution
The liquid flows back from the pump into the storage tank.	The HanskampQualityTube is leaking. The rollers are worn. The bearing is worn.	Replace the hose. Replace the rollers. Replace the bearing.
The fluid runs out of the nozzle when the engine is idle.	Air infiltration between the pump and the nozzle. Or nozzle is not mounted vertically	Press the pressure hose onto the nozzle again. Check or improve the seal between the fitting and the nozzle. Mount the nozzle completely vertically.
The motor runs but it doesn't pump any liquid.	The suction hose is blocked. Rotor is installed the wrong way.	Clean the suction hose (if necessary, blast air through it). Install the rotor in the right way.
Leaking feed-through coupling.	Hose too loose on the coupling.	Fit a hose clamp (art. no. 003-547-000) on the coupling/hose.

**Declaration of incorporation of complete machines IIA**

According to Annex IIA of the Machinery Directive 2006/42/EC, for completed machines

We,  
Hanskamp AgroTech BV  
Broekstraat 17  
7009 ZB Doetinchem  
The Netherlands,

Authorised compiler(s) of the technical file:

H.J. Hanskamp,

declare under our sole responsibility that the following product:

37000 MultiDos HighSpeed (24VDC),  
Universel dosing system for liquids,

to which this declaration relates, complies with the provisions of the following directive (s):

- Machinery Directive 2006/42/EC

The product also complies with the provisions of the following standards:

- NEN-EN-IEC 60204-1
- NEN-EN-ISO 12100:2010
- NEN-5509
- NEN-EN 349
- NEN-EN-ISO 13857

**If the MultiDos is not connected and the prescribed safety instructions are not used, this Declaration of Conformity is not applicable and no rights can be derived from this declaration.**

Doetinchem, The Netherlands, 01-10-2019

H.J. Hanskamp



## Appendix 1 Information nozzle holders 003-533-001

Drill holes to mount the hose and nozzle, insert the hose through the center hole and mount the nozzle to the hose.



**Attention! Always mount the nozzle vertically.**

003-533-001

Shielded installation

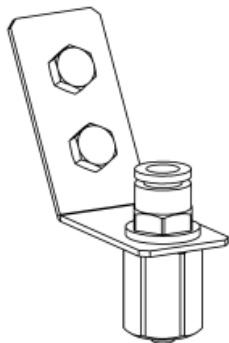

Hole distances 003-533-000

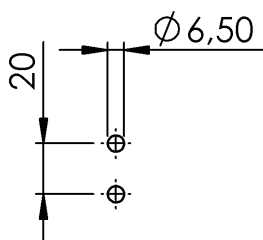

Shielded installation; cow can't reach nozzle.

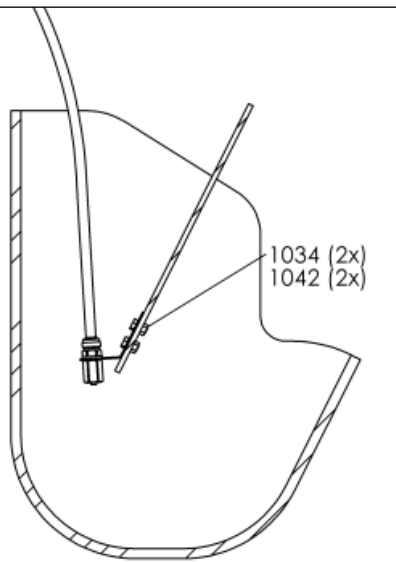

**Note: the liquid must not be dosed over the nose of the cow.**

## Appendix 2 Article number build-up and exploded view MultiDos HighSpeed pump

Art. No. **037-323-000**

Productgroup	Color	Motor	Type
037 = MultiDos HS	1 = Black 2 = Green 3 = Blue 4 = Red 5 = Orange	1 = DC 120RPM (no longer available) 2 = DC 200RPM	3 = wallmount type

Example: Art. No. 037-323-000 =

- A MultiDos HighSpeed 200RPM 24VDC;
- Consists of 1 pump;
- Built in blue wall mount cover.

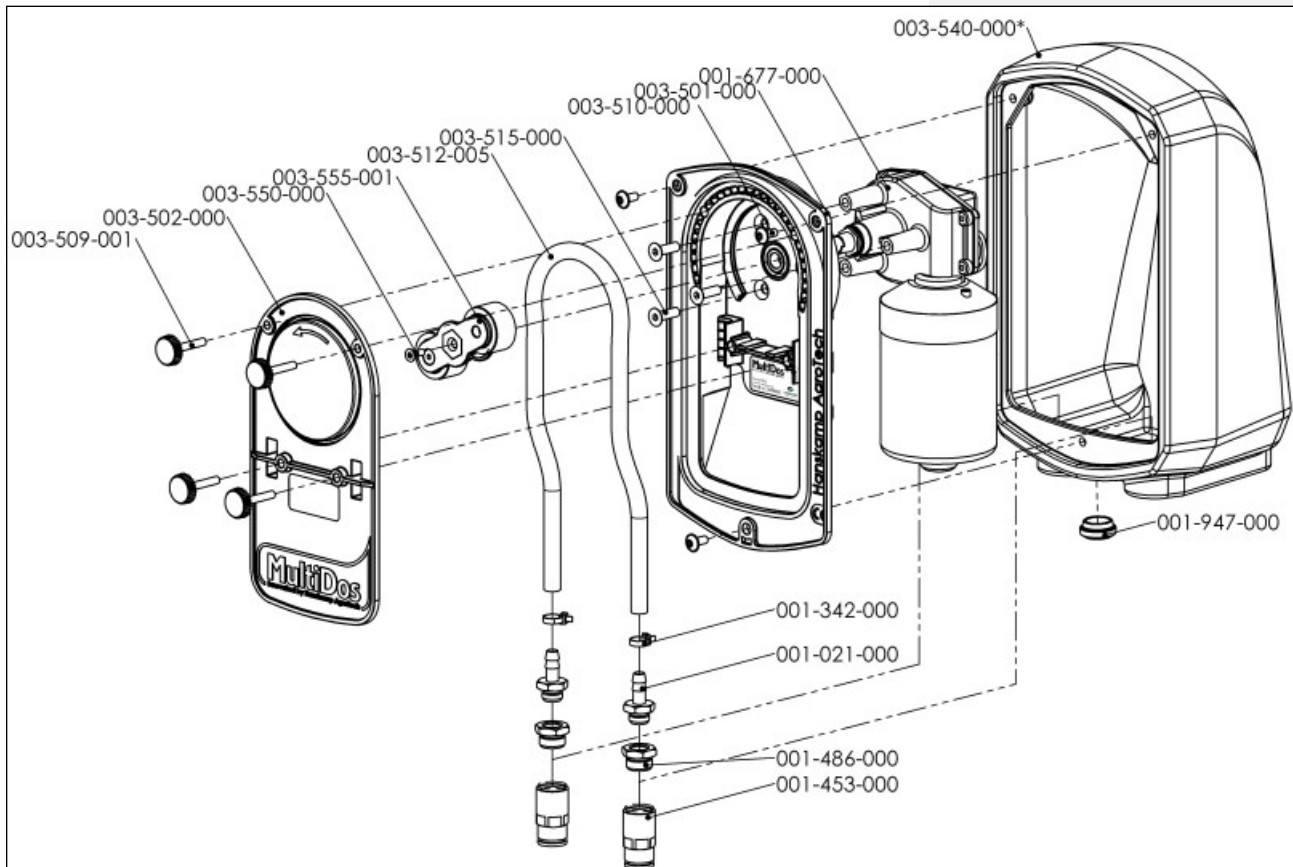



### Appendix 3 Hazard warnings and use instructions HanskampQualityTube

003-512-00\* HanskampQualityTube

Warnings and usage instructions for dealers, sellers and users of the MultiDos HighSpeed.



**Caution! The HanskampQualityTube is not intended for medical use!**

Read these warnings and instructions carefully before use or resale of the MultiDos HighSpeed.

The following warnings and instructions must be followed to prevent breaks or leaks in the hose, which could result in damage to property and/or personal injury during use.

#### Warnings

1. The HanskampQualityTube is made of thermoplastic, and its performance depends on the temperature and pressure.
2. Some liquids can be absorbed or extracted by the HanskampQualityTube. The end user is responsible for observing and documenting the specifications, safety regulations and documentation of the HanskampQualityTube.
3. The end user is responsible for determining the suitability of the hose formulation for the application.
4. The HanskampQualityTube is not intended or suitable for medical applications. The use of this hose in a medical application is the sole responsibility of the dealer and/or end user.
5. To avoid catastrophic disconnection during use, detachable clamps must always be used when attaching the hose to a coupling or fitting.
6. The end user is advised to have a back-up system available in case the hose ruptures.
7. No hose will last forever, and this also applies to hoses used in the MultiDos HighSpeed; following prolonged use or improper installation, the hose will rupture.

The following factors will affect the service life of the HanskampQualityTube in the MultiDos HighSpeed liquid pump:

- The liquid being pumped;
- Percentage closure of the hose wall;
- Pump speed (in combination with roller strokes per minute) and total number of strokes;
- System back pressure;
- Temperature of the fluid being transported and ambient temperature;
- Frictional resistance due to deficient maintenance or wear on the rollers and guides;
- Twisted, kinked or excess length of the HanskampQualityTube installed in the MultiDos HighSpeed;
- Wall thickness and thickness variation.

To prevent any damage to property, or consequential damage, always do the following when using the HanskampQualityTube in the MultiDos pump:

- Carefully set up and monitor each of the factors mentioned above while using the HanskampQualityTube in the MultiDos HighSpeed;
- Read and heed the instructions of Hanskamp (manufacturer) or (milking machine) dealer of the apparatus, the MultiDos HighSpeed, regarding HanskampQualityTube installation, pump rollers, guide rollers and supply channel maintenance and calibration.
- Inspect the HanskampQualityTube for any damage prior to installation.
- Check that the HanskampQualityTube proper length is contained in the raceway portion of the pump and that the tubing is not twisted or kinked.
- Always constantly monitor the tubing circuit during actual procedures for signs of the HanskampQualityTube beginning to crack, leaks, or air infusion and take appropriate action when observed.

Material safety data sheets are always available from Hanskamp.

## Appendix 4 Loose parts

For maintenance or for whatever reason it is possible to separate parts be ordered from your dealer. Please use therewith as are indicated. Below the drawing item numbers.

Parts MultiDos HighSpeed		
Art. no.	Description	Quantity
001-021-000	Hose pillar ¼" x 9	2
001-453-000	Push-in 3/8" bi x 12mm	2
001-486-000	Reducing ring 3/8" bu—¼" bi	2
001-677-000	Dosing motor 200RPM 24VDC	1
001-947-000	Membrane grommet	1
003-510-000	Socket screw with flange M5x10 a2	3
003-512-005	HanskampQualityTube Q-prene hose	1
003-515-000	Countersunk Hexagon socket screw M6x20	3
003-525-000	MultiDos HS pump complete with lid	1
003-533-001	Spray nozzle complete for Multi-Dos HS	1
003-555-001	Rotor assembly complete for MD HS	1
003-573-000	Shaft circlip ring for MD HS	1
082-254-100	Air tube PA12W/25m 12x10 natural	0,1
082-254-100	Air tube PA12W/25m 12x10 natural	0,4

Parts MultiDos HighSpeed wall mount version		
Art. no.	Description	Quantity
003-517-000	Wall bracket for wall mounting 1mm	1
005-556-013	DIN rail l=110 mm	1
001-955-000	Sheet metal screw Ckkk 4x13 stainless steel A2	4

MultiDos HighSpeed pump		
Art. no.	Description	Quantity
003-501-000	Pump housing MultiDos High-Speed	1
003-502-000	Cover pump MultiDos HS transparent	1
003-507-000	Bearing 6000RS 10x26x8 RVS	1
003-509-001	Knurling bolt M5x29 a2	4
003-519-000	Multisert 003-M5 inserts	4
010-066-000	Sticker with serial no. for pump housing MD HS	1

Parts 003-555-001 rotor MultiDos HighSpeed		
Art. no.	Description	Quantity
003-503-000	Rotor part MultiDos HS red	2
003-504-001	Plastic roller Ø35.0mm	2
003-507-000	Bearing	2
003-508-000	Circlip	2
003-516-000	Countersunk Hexagon socket screw	2
003-549-000	Adapter SW17 for MD-HS	1

Color options wall mount	
Art.no.	Description
003-520-000	Wall mount MultiDos HS black with 3 inserts
003-540-000	Wall mount MultiDos HS green with 3 inserts
003-541-000	Wall mount MultiDos HS bleu with 3 inserts
003-542-000	Wall mount MultiDos HS red with 3 inserts
003-543-000	Wall mount MultiDos HS orange with 3 inserts

Hanskamp AgroTech BV  
Xenonstraat 6  
7031 HX Wehl  
The Netherlands  
Tel: +31 (0)314 - 393 797  
[www.hanskamp.com](http://www.hanskamp.com)

Also take a look at:

